



# Building: Our Mission, Our Faith, Our Future

---

Information Meetings  
April 25, 26 and 30



# The Great Commission

---

- Matthew 28:19-20

“Go therefore and make disciples of all nations, baptizing them in the name of the Father and of the Son and of the Holy Spirit, [20] and teaching them to obey everything that I have commanded you. And remember, I am with you always, to the end of the age.”



# The Current Situation

---

- While Worship is dynamic, Sunday School program is limited by space considerations and we can expect further growth
- We don't have any place that we can gather as a congregation
- Parking lot needs a better surface
- Narthex is too crowded at coffee hour
- Little space available for office use



# Trends in Sunday School Attendance

---

Actual and Projected Growth in Sunday School Attendance

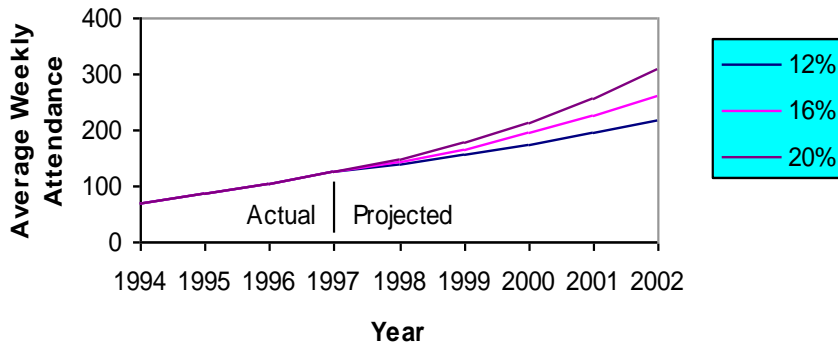

- Sunday School attendance has increased by an average of 20% in the last 3 years
- Already above capacity

**Momentum is crucial to growth!**



# Trends in Worship Attendance

---

Actual and Projected Growth in Average Worship Attendance

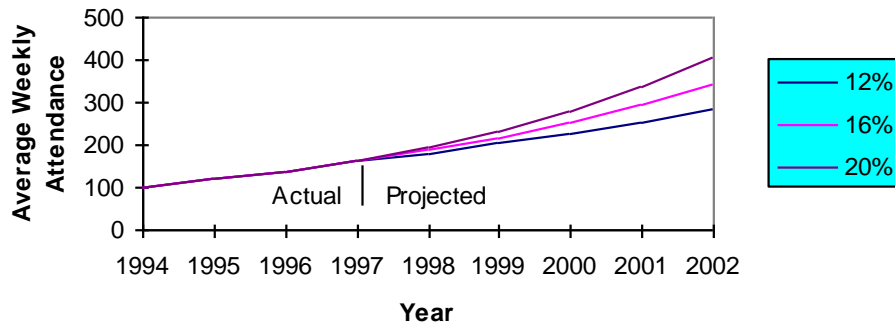

- Growth in monthly worship has averaged 17% in the past 3 years
- Project attendance in heaviest months to exceed comfortable capacity within a few years



# Demographic Projections of Growth

---

- Area continues to grow rapidly
- New residents will be:
  - ◇ Young with young families
  - ◇ Two-career
  - ◇ Highly educated
  - ◇ More racially diverse



# Needs in the Next Few Years

---

- Sunday School Space
- Fellowship Space
- Additional Nursery Space
- Additional Office Use Space
- Increased Narthex and Sanctuary Space
- Some Additional Parking
- Space for Additional Ministries (Preschool, Sports and Multi-use space)



# Important Considerations

---

- We need more space for Sunday School now
- New space takes several years to construct
- We are making our mortgage and principal payments, but we can't borrow additional funds commercially



# Current Plans

---

- **Fellowship Hall** will provide multipurpose space for youth activities, sports and informal worship (46' x 70'; 3220 sq. ft)
- **Sunday School space** will include room for 5 large classrooms, 4 smaller class rooms and 2 bathrooms (36' x 69'; 2,504 sq. ft.)



# Overview of Expansion Design Plans

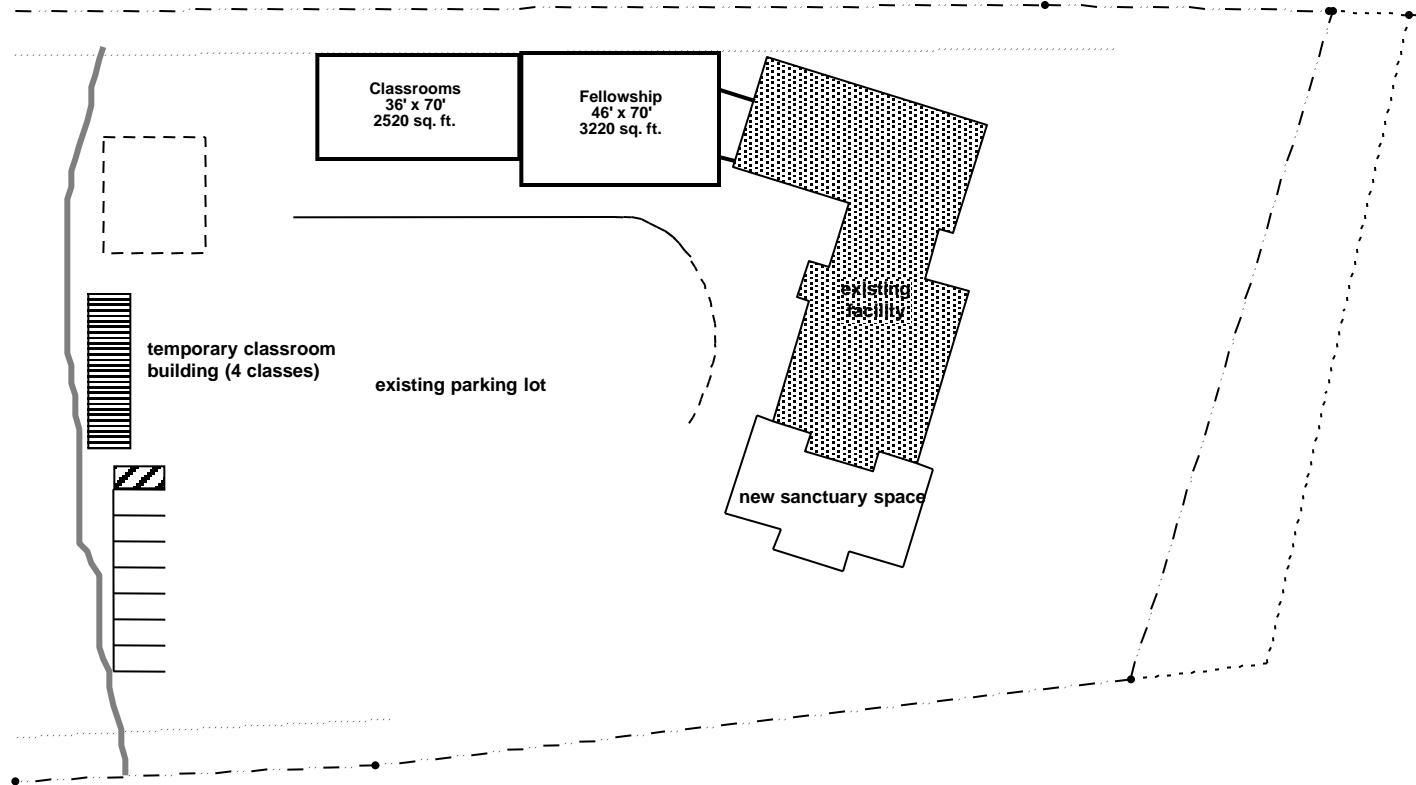

## Prince of Peace Lutheran Church

Expansion Master Plan  
Scale 1:50



# Overview of Expansion Design Plans

---





# Overview of Expansion Design Plans

---





# Upcoming Events

---

- Intensive Period of Campaign  
April 30-June 3
- Special Event - May 21
- Commitment Visits – May 30-June 4
- Celebration Sunday – June 4